

HNSA thanks Ed Zajkowski for his generous loan of the original document used to create this online version.

We also appreciate the help of Oce North America for their assistance in scanning this document.

~~49~~

BUREAU OF SHIPS
CONTRACT DRAWING NO.
1,399,481
SHEET 1 of 10

USS

(ARC-3)

Approved *Charles A. Centze* Date *5-10-55*

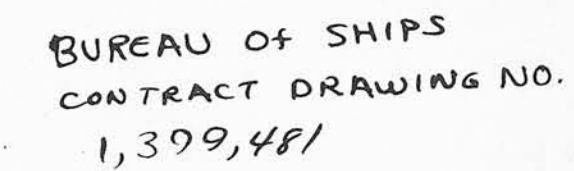

ARC
INBOARD PROFILE
SCALE 1/16" = 1"

Approved Charles A. County Date 5-10-55

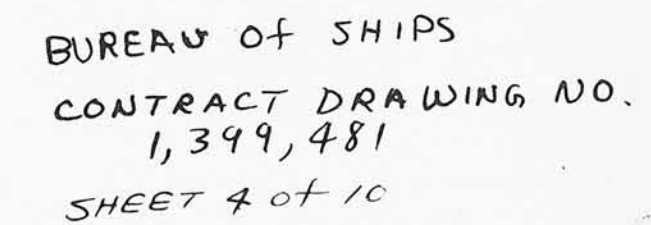

SCALE 1/2

Approved Charles A. Custer Date 5-10-58

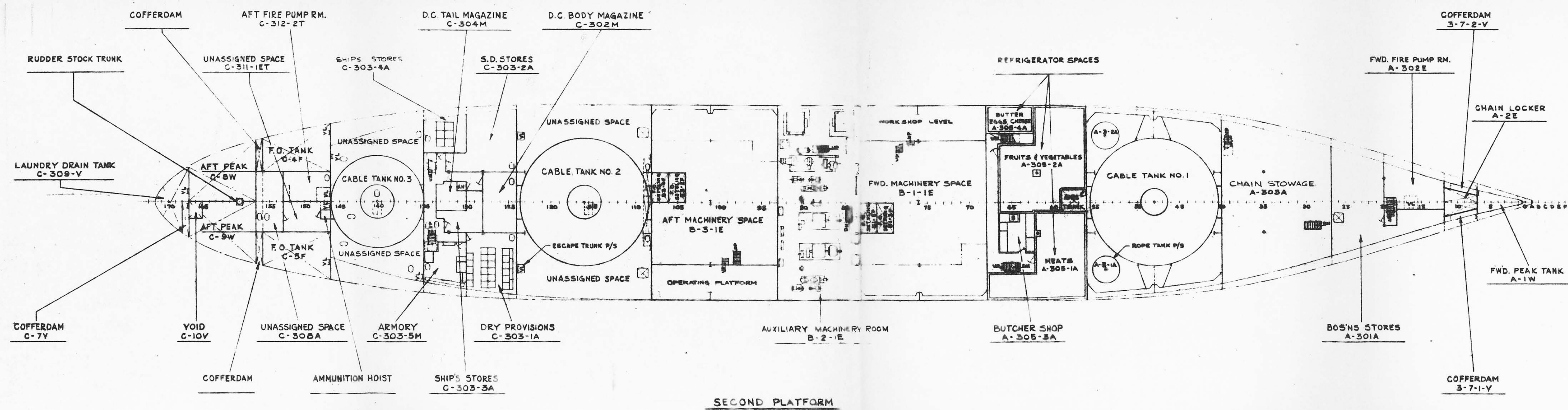

BUREAU OF SHIPS
 CONTRACT DRAWING NO.
 1,399,481
 SHEET 7 of 10

ARC 2
 SECOND PLATFORM
 SCALE 1/16"=1'-0"

Approved *Charles A. Luge* Date 5-10-55

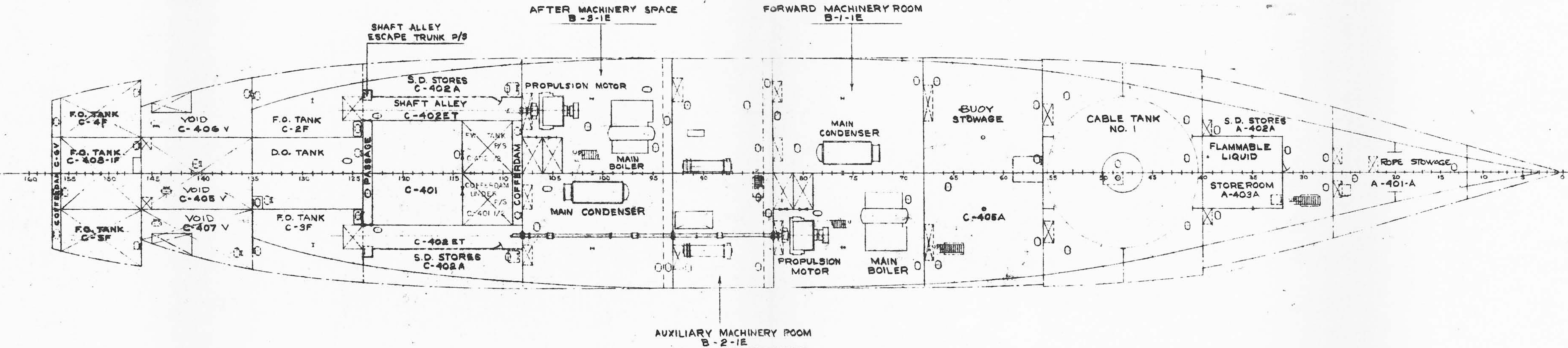

BUREAU OF SHIPS
 CONTRACT DRAWING NO.
 1,349,481
 SHEET 8 of 10

ARC 4
 HOLD
 SCALE 1/16" = 1'-0"

Approved *Charles A. Lutz* Date 5-10-55

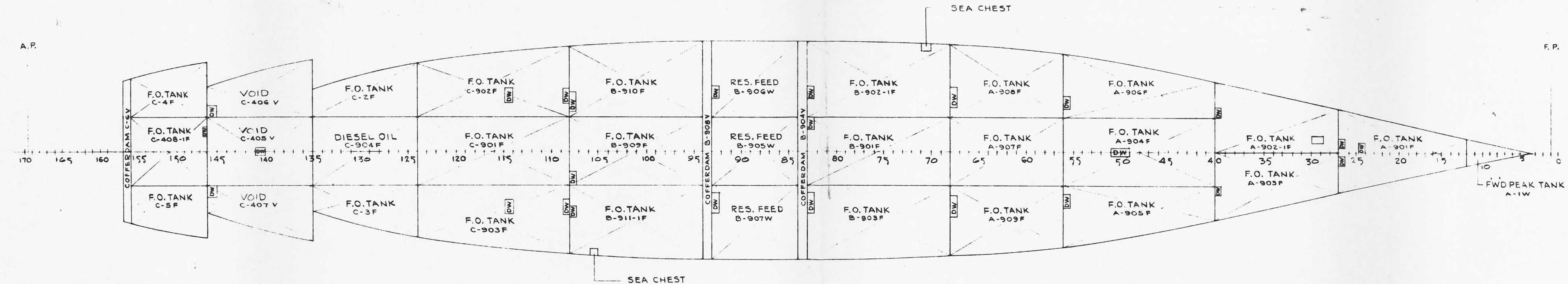

BUREAU of SHIPS
CONTRACT DRAWING NO.
1,399,481

SHEET 9 of 10

ARC 4

INNERBOTTOM
SCALE 1/16" = 1' 0"

Approved *Charles A. Lutz* Date 5-10-55

TOP OF HOUSE
(59'-6" ABV. B.L.)

NAVIGATING DECK
(52'-0" ABV. B.L.)

SUPERSTRUCTURE DECK
(44'-6" ABV. B.L.)

UPPER DECK
(37'-0" ABV. B.L.)

MAIN DECK
(28'-6" ABV. B.L.)

FIRST PLATFORM

SECOND PLATFORM

ENGINE ROOM FLOOR

INNER BOTTOM

BASE LINE

RADIO I
B-0301C

MAIN COMM. STATION
B-0301C

OFFICERS S.R.
B-0201L

PASS.
B-0201LT

OFFICERS S.R.
B-0201L

OFFICERS MESS
B-0101L

PASS.
B-0101LT

OFFICERS S.R.
B-0101L

WEATHER
DECK

4-CREW
B-102-L

PASS.
B-102-LT

2-CREW
B-102-L

BOILER CASING
B-1-1E

PASS.
B-102-LT

4-CREW
B-102-L

WEATHER
DECK

FIRST
PLATFORM
FLAT

FORWARD
MACHINERY
SPACE
B-1-1E

FORWARD
MACHINERY
SPACE
B-1-1E

WORKSHOP
LEVEL

WORKSHOP
LEVEL

15'D

15'x27'

15'x27'

15'x27'

15'x27'

15'x27'

15'x27'

15'D

FRAME 76
LOOKING FWD

BUREAU OF SHIPS
CONTRACT DRAWING NO.
1,399,481

SHEET 10 of 10

ARC 4
MIDSHIP FRAME 76
SCALE 1/4" = 6'

Approved *Charles A. Clark* Date 5-10-55