

Apr 07, 2020 - 5:18pm. Plotted By: kurt.leader V:\026800-Panda Express - Master 2018\026800.05-Canal Winchester, OH\04-DWG\Envt Sheet\026800.05-SUTS-C6540.dwg Layout: Grad. Detail

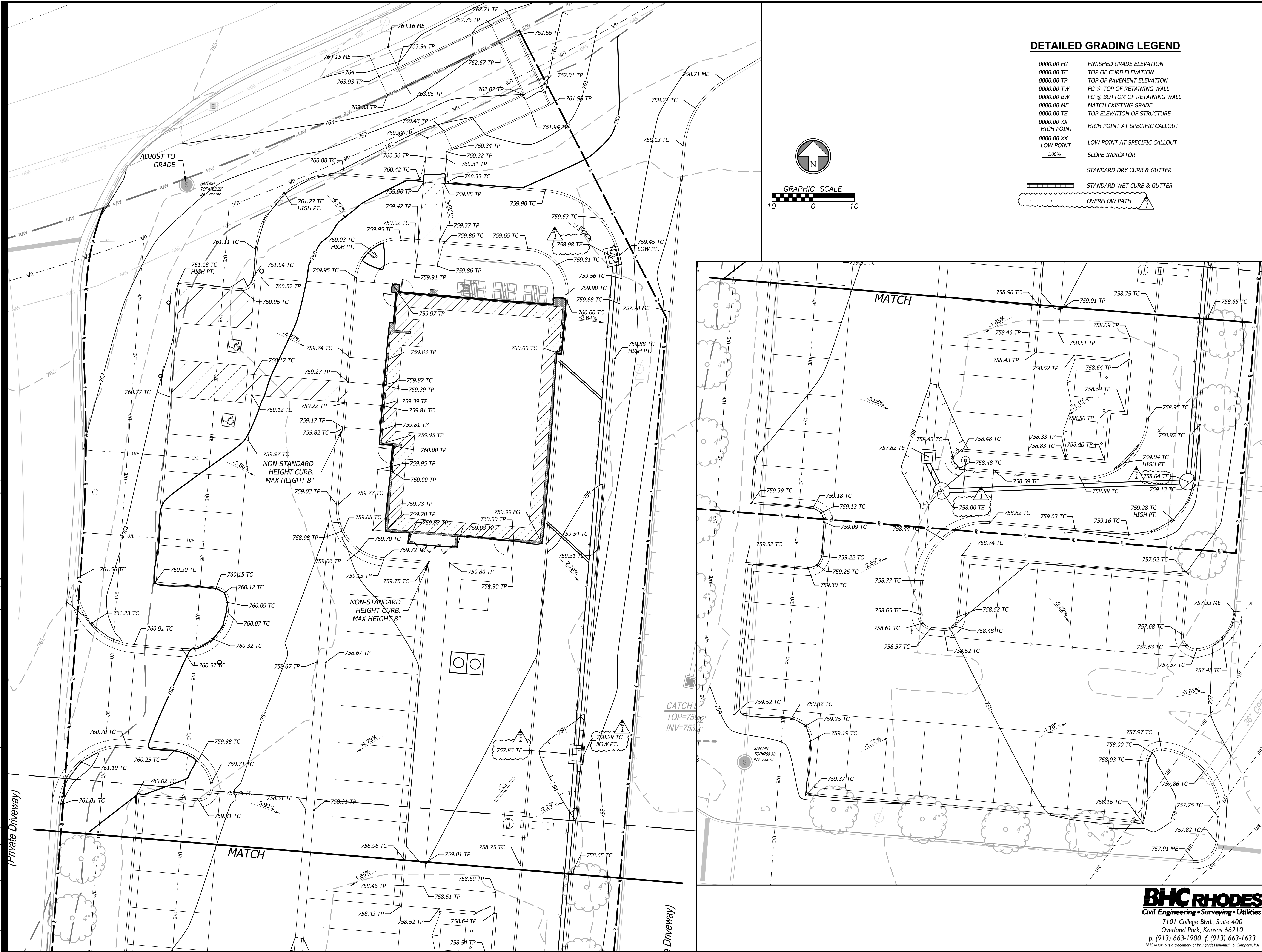

PANDA EXPRESS, INC.
1683 Walnut Grove Ave.
Rosemead, California
91770
Telephone: 626.799.9898
Facsimile: 626.372.8288

All ideas, designs, arrangement and plans indicated or represented by this drawing are the property of Panda Express Inc. and were created for use on this specific project. None of these ideas, designs, arrangements or plans may be used by or disclosed to any person, firm, or corporation without the written permission of Panda Express Inc.

REVISIONS:
1 TECHNICAL REVIEW GROUP 03.17.20

ISSUE DATE:
1st PERMIT/BID SET 01-13-20

DRAWN BY:

PANDA PROJECT #: S8-20-D6790
ARCH PROJECT #: 18044.035



hckloverarchitect
8813 Penrose Lane, Suite 400,
Lenexa, KS 66219
ph: 913.649.8181 • fx: 913.649.1275

PANDA EXPRESS
TRUE WARM & WELCOME 2300 R1
CANAL ST. & WINCHESTER BLVD
CANAL-WINCHESTER, OH 43110

DETAILED GRADING PLAN

C3.2

TRUE WARM & WELCOME 2300 R1

BHC RHODES
Civil Engineering • Surveying • Utilities
7101 College Blvd., Suite 400
Overland Park, Kansas 66210
p. (913) 663-1900 f. (913) 663-1633
BHC RHODES is a trademark of Brungardt Honnrich & Company, P.A.

PERMIT/BID SET 01-13-20