

GENERAL DEMOLITION NOTES

1. ALL ITEMS TO BE PROTECTED SHALL BE PROTECTED THROUGH ALL THE PHASES OF CONSTRUCTION UNTIL FINAL ACCEPTANCE BY CITY OF RIVERDALE/CLAYTON COUNTY IS RECEIVED.
2. CONTRACTOR TO COMPLY WITH ALL LOCAL, STATE, AND FEDERAL REQUIREMENTS WITH ALL DEMOLITION ACTIVITIES. IF ADDITIONAL REQUIREMENTS ARE REQUIRED FOR HAZARDOUS WASTE REMOVAL INCLUDING BUT NOT LIMITED TO ASBESTOS, SEPTIC FIELDS, LEAD, PCB, TCE, OR OTHER WASTE OR CONTAMINANT, IT IS THE CONTRACTORS RESPONSIBILITY TO COMPLY WITH HAZARDOUS WASTE REMOVAL REQUIREMENTS.
3. CONTRACTORS SHALL COORDINATE WITH ALL UTILITY COMPANIES CONCERNING THE ABANDONMENT, RELOCATION AND/OR DEMOLITION OF UTILITIES PRIOR TO CONSTRUCTION. NO WORK IS TO BE PERFORMED ON LIVE LINES UNLESS APPROVED IN WRITING BY THE UTILITY IN ALL CASES. A REPRESENTATIVE FROM THE UTILITY SHALL BE PRESENT FOR INITIAL ABANDONMENT AND/OR LIVE CUTS. CONTRACTOR SHALL USE EXTREME CAUTION WHEN WORKING NEAR UTILITIES AND SHALL PROTECT THEM AT ALL TIMES.
4. CONTRACTOR IS RESPONSIBLE FOR PROCUREMENT OF ALL NECESSARY PERMITS.
5. DEMOLITION SHALL INCLUDE ALL LABOR, EQUIPMENT, MATERIALS, HAULING, PERMITTING, FEES, AND COORDINATION WITH PUBLIC AND/OR PRIVATE UTILITY REQUIRED TO REMOVE AND PROPERLY DISPOSE OF ANY ITEM NECESSARY TO PERFORM THE REQUIRED DEMOLITION AS INDICATED ON THE PLANS.
6. RELOCATION SHALL INCLUDE ALL LABOR, EQUIPMENT, MATERIALS, HAULING, PERMITTING, FEES, AND COORDINATION WITH PUBLIC AND/OR PRIVATE UTILITY REQUIRED TO REMOVE, RELOCATE, AND INSTALL NEW ITEMS AS INDICATED ON THE PLANS.
7. ABANDONMENT SHALL INCLUDE ALL LABOR, EQUIPMENT, MATERIALS, PERMITTING, FEES, AND COORDINATION WITH PUBLIC AND/OR PRIVATE UTILITY REQUIRED TO ADEQUATELY ABANDON ITEMS AS INDICATED ON THE PLANS.
8. THE CONTRACTOR SHALL COORDINATE ALL TREE AND LANDSCAPE REMOVAL WITH THE LANDSCAPE PLANS. ANY DISCREPANCY BETWEEN THIS DEMOLITION PLAN AND THE LANDSCAPE PLANS SHALL BE BROUGHT TO THE ATTENTION OF THE OWNER IMMEDIATELY.
9. THE CONTRACTOR IS FULLY AND COMPLETELY RESPONSIBLE FOR LOCATION VERIFICATION, PROTECTION, STORAGE, MAINTENANCE, DEMOLITION, REMOVAL, RELOCATION OR ALTERATION OF ALL EXISTING SITE UTILITIES, SITE IMPROVEMENTS, STRUCTURES, OR CONSTRUCTION ELEMENTS AS REQUIRED TO COMPLETE THE WORK THAT ARE SHOWN ON THE PLANS AND OR THAT ARE OBSERVABLE IN THE FIELD, WHETHER CONSPICUOUSLY VISIBLE OR NOT. THE CONTRACTOR SHALL VISIT THE SITE AND BECOME THOROUGHLY FAMILIAR WITH ALL EXISTING IMPROVEMENTS, UTILITIES, AND SITE CONDITIONS PRIOR TO BIDDING AND CONSTRUCTION.
10. THIS DEMOLITION PLAN IS FOR GRAPHICAL REFERENCE ONLY. ITEMS NOT DEPICTED ON THESE PLANS MAY BE REQUIRED TO BE PROTECTED, REMOVED, OR RELOCATED. THE CONTRACTOR IS RESPONSIBLE FOR FIELD VERIFYING THE LOCATIONS OF ALL EXISTING STRUCTURES, UTILITIES, AND APPURTENANCES WITHIN THE LIMITS OF CONSTRUCTION. DEMOLITION INCLUDES BUT IS NOT LIMITED TO THE ITEMS SHOWN ON THIS PLAN.
11. THE CONTRACTOR SHALL USE EXTREME CAUTION WHEN WORKING NEAR ANY EXISTING UNDERGROUND OR OVERHEAD UTILITIES.
12. SAWCUT DIMENSIONS SHOWN ARE APPROXIMATE. CONTRACTOR SHALL FIELD STAKE AND CONSULT ENGINEER TO VERIFY PRIOR TO CONSTRUCTION.

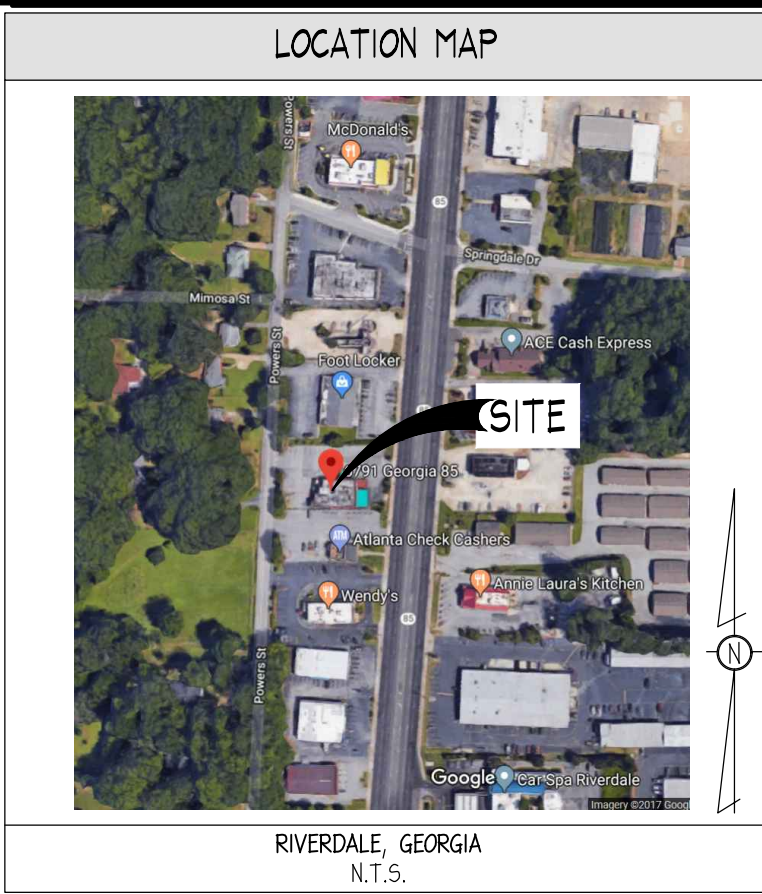

ingenium
PLANNING & ENGINEERING
220 ROSWELL ST.
SUITE 100
ALPHARETTA, GA 30009
770.457.8850
INGENIUM@GMAIL.COM

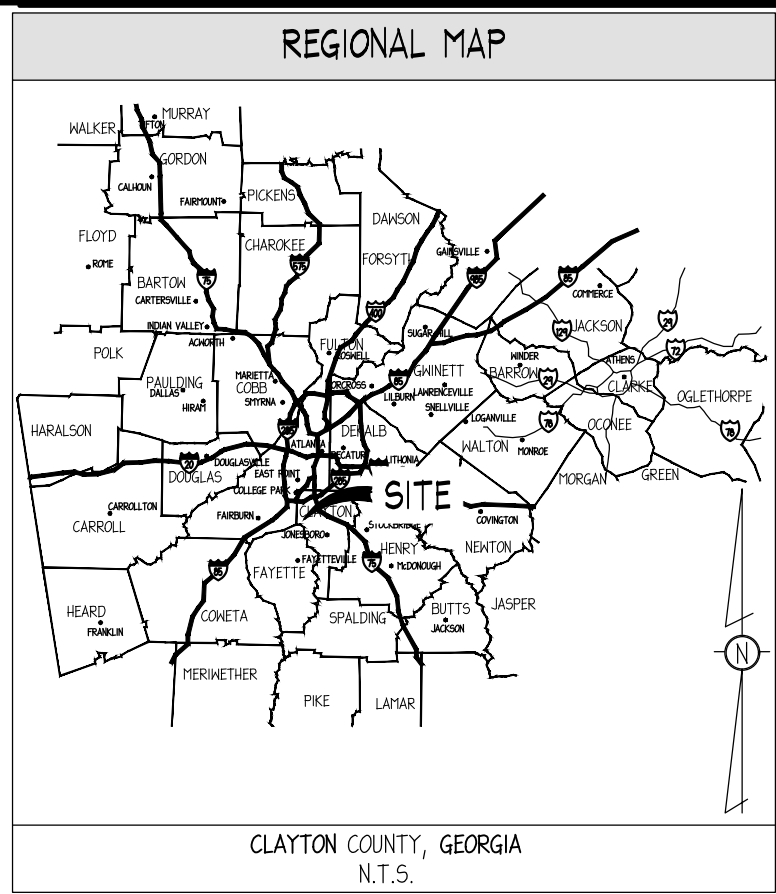

DEMOLITION LEGEND

1. PROTECT ALL ITEMS DURING ALL PHASES OF CONSTRUCTION (SEE GENERAL DEMOLITION NOTE #1). THE CONTRACTOR SHALL ENSURE THE INTEGRITY OF ALL ITEMS DEEMED TO BE PROTECTED THAT ARE ADJACENT TO ITEMS DEEMED TO BE DEMOLISHED AND WILL SAFELY REPAIR ANY SUCH ITEMS TO THE REQUIRED JURISDICTIONAL STANDARDS.
2. SAWCUT AND REMOVE EXISTING CONCRETE CURB AND GUTTER AND ASSOCIATED APPURTENANCES INCLUDING, BUT NOT LIMITED TO, REINFORCEMENT AND STONE BASE.
3. REMOVE EXISTING BUILDING AND ASSOCIATED APPURTENANCES INCLUDING, BUT NOT LIMITED TO, WALLS, AWNINGS, CANOPY, ROOF, ROOF-TOP MECHANICAL EQUIPMENT, FOUNDATION, FOOTINGS, UTILITIES WITHIN SLAB, FRENCH DRAINS, STEPS/STAIRS, CONCRETE PARKING AND STONE BASE.
4. REMOVE EXISTING ASPHALT AND CONCRETE SIDEWALK AND ASSOCIATED APPURTENANCES INCLUDING, BUT NOT LIMITED TO, REINFORCEMENT AND STONE BASE.
5. CONTRACTOR SHALL CLEAN OUT EXISTING DROP INLET AND ADJUST TOP TO GRADE. SEE STORM PROFILE SHEET.
6. REMOVE EXISTING GAS LINE AND METER AND ALL ASSOCIATED APPURTENANCES. SEE GENERAL DEMOLITION NOTE #3.
7. DISCONNECT ELECTRIC AND TELEPHONE SERVICE TO EXISTING BUILDING AND COORDINATE WITH UTILITY PROVIDER. SEE GENERAL DEMOLITION NOTE #3. REMOVE EXISTING OVERHEAD POWER LINES AND ALL ASSOCIATED APPURTENANCES.
8. REMOVE EXISTING LIGHT POLES, INCLUDING FOOTER AND CONCRETE BASE AND ALL ASSOCIATED APPURTENANCES.
9. REMOVE EXISTING BRICK WALL AND COLUMNS AND ALL ASSOCIATED APPURTENANCES.
10. REMOVE EXISTING GREASE TRAP AND ALL ASSOCIATED APPURTENANCES INCLUDING PIPES.
11. REMOVE CHAIN LINK FENCE AND ALL ASSOCIATED APPURTENANCES.
12. REMOVE EXISTING 4" SEWER STUB AND PLUG AND ALL ASSOCIATED APPURTENANCES PER CLAYTON COUNTY WATER AUTHORITY (CCWA) STANDARDS.
13. REMOVE EXISTING BOLLARDS AND WOOD TIMBERS AND ALL ASSOCIATED APPURTENANCES.

CONTRACTOR RESPONSIBLE FOR OBTAINING APPROPRIATE ASBESTOS REMOVAL PERMIT PRIOR TO DEMOLITION OF BUILDING.

CONTRACTOR SHALL PROTECT ALL ITEMS OUTSIDE LIMITS OF CONSTRUCTION UNLESS OTHERWISE NOTED IN THE CONSTRUCTION PLANS OR SPECIFICATIONS.

CONTRACTOR SHALL FIELD VERIFY ALL EXISTING UTILITIES (LOCATIONS AND ELEVATIONS) PRIOR TO STARTING CONSTRUCTION AND ALERT ENGINEER TO ANY DISCREPANCIES IMMEDIATELY.

24-HOUR CONTACT:
KYLE GIBSON
972-974-4524



Know what's below.
Call before you dig.

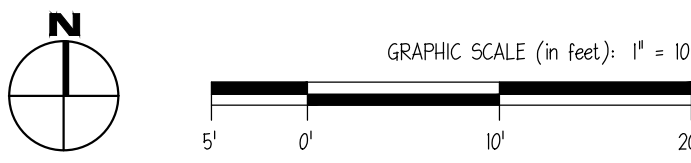

DEL TACO
6791 GEORGIA HIGHWAY 85
RIVERDALE, GEORGIA



CLIENT:
GUGGENHEIM
DEVELOPMENT
SERVICES, LLC
3000 INTERNET BOULEVARD,
SUITE 570
FRISCO, TEXAS 75034
PHONE: 214-872-4000

REVISION HISTORY	
1	ISSUED FOR PERMIT

THE CIVIL ENGINEER REGULARLY UPDATES ELECTRONIC FILES DURING THE DEVELOPMENT OF A PROJECT. AS A RESULT, THE DATA INCLUDED IN ANY CAD FILE OR DRAWING PRIOR TO ITS FINAL RELEASE DOES NOT NECESSARILY REFLECT THE COMPLETE, PRELIMINARY, INCOMPLETE, WORK IN PROGRESS, AND SUBJECT TO CHANGE. FURTHERMORE, THE INFORMATION CONTAINED HEREIN IS THE SOLE PROPERTY OF THE CIVIL ENGINEER. THE ORIGINAL DESIGN REPRESENTED HEREIN BY THIS INFORMATION SHALL NOT BE USED, ALTERED, OR REPRODUCED IN ANY MANNER WITHOUT THE EXPRESSED WRITTEN CONSENT OF THE CIVIL ENGINEER. THESE PLANS ARE SUBJECT TO FEDERAL COPYRIGHT LAWS AND USE OF SAME WITHOUT EXPRESSED WRITTEN PERMISSION OF THE CIVIL ENGINEER IS PROHIBITED.

PROJ # 180049
DWG NAME 180049_C02.DWG
ISSUE DATE 08/31/2018
PROJ TGR: LB

DEMOLITION PLAN

C02.2

SHEET NUMBER

ISSUE FOR PERMIT