



PANDA EXPRESS, INC.
1683 Walnut Grove Ave.
Rosemead, California
91770
Telephone: 626.799.9898
Facsimile: 626.372.8288

All ideas, designs, arrangement and plans indicated or represented by this drawing are the property of Panda Express Inc. and were created for use on this specific project. None of these ideas, designs, arrangements or plans may be used by or disclosed to any person, firm, or corporation without the written permission of Panda Express Inc.

REVISIONS:		

ISSUE DATE:		
1st	BUILDING PERMIT SET	04-02-21

DRAWN BY:	KB
PANDA PROJECT #:	S8-22-D8193
PANDA STORE #:	-
ARCH PROJECT #:	20044.021



hckloverarchitect
8813 PENROSE LANE, SUITE 400
LENEXA, KS 66219
ph: 913.649.8181 • fx: 913.649.1275

PANDA EXPRESS
TRUE WARM & WELCOME
1485 MAIN ST.
HAMILTON, OH 45013

E-101.1
CANOPY LIGHTING PLAN
TRUE WARM & WELCOME 2300 R5

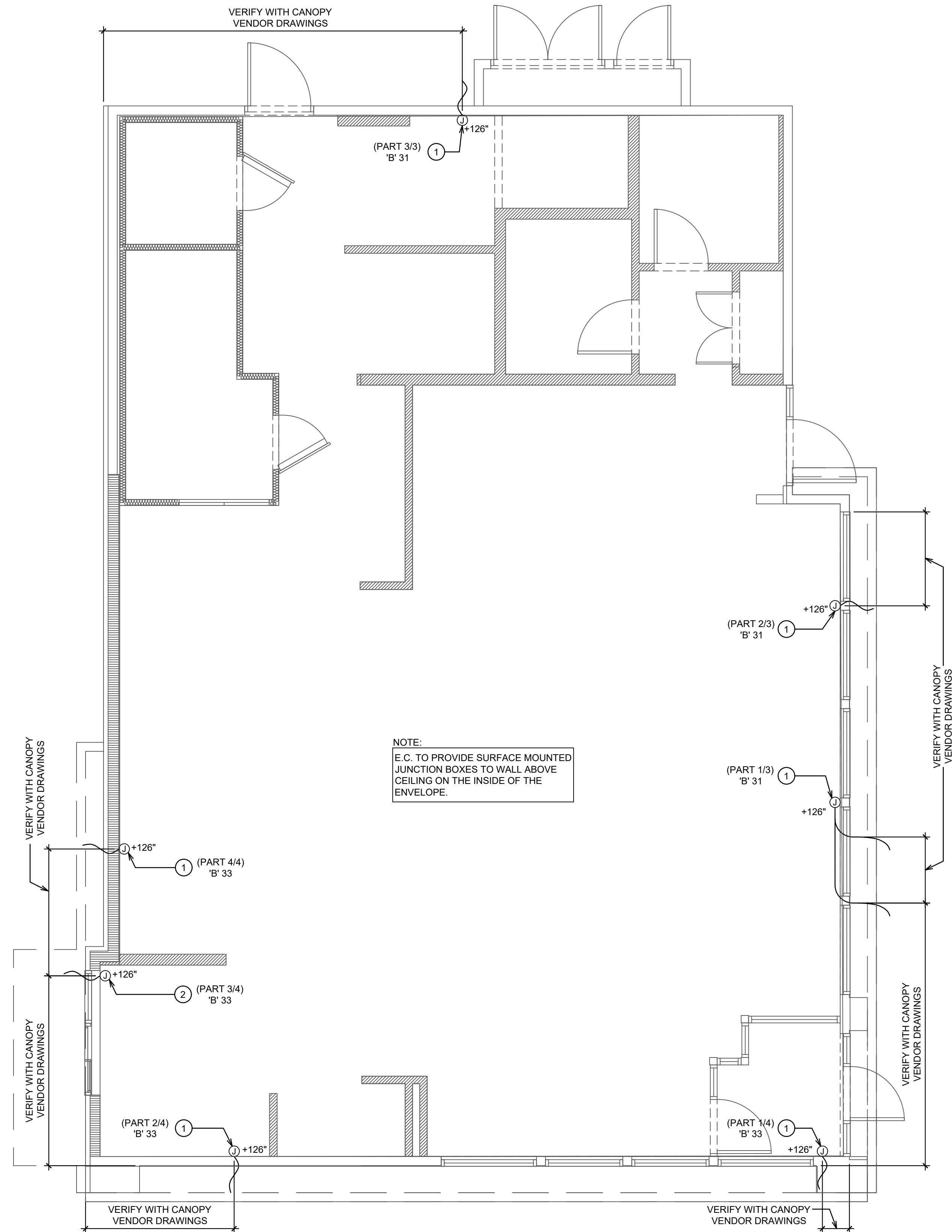

ALL JUNCTION BOXES ON THIS SHEET TO BE RECESS MOUNTED.		
CANOPY LIGHTING GENERAL NOTES		3
NOT TO SCALE		E-101.1
1. E.C. TO PROVIDE J-BOX WITH 3' WHIP FOR CONNECTION TO PANDA EXPRESS PROVIDED LIGHTED CANOPY. E.C. TO MAKE FINAL CONNECTION.		
2. E.C. TO PROVIDE J-BOX WITH 3' WHIP FOR CONNECTION TO PANDA EXPRESS PROVIDED LIGHTED DRIVE THRU CANOPY. E.C. TO MAKE FINAL CONNECTION.		
3. ALL JUNCTION BOXES ON THIS SHEET TO BE RECESS MOUNTED.		
# CANOPY LIGHTING KEYED NOTES		2
NOT TO SCALE		E-101.1

CANOPY LIGHTING PLAN		1
Scale: 1/4"=1'-0"		E-101.1